

M / Y L A D Y S A R Y A



LADY SARYA

Lady Sarya

A legendary 76m yacht, built in 1972 by Rinaldo Gastaldi in Nuovi Cantieri Apuania in Marina di Carrara, Italy, especially for New York property developer William Levitt.

The yacht is characterized by the unmistakable twin funnels with a large swimming pool positioned between them on the upper deck.

She has a gross tonnage of 1,031, a steel hull with an aluminum superstructure and teak decks.

Lady Sarya can accommodate 11 guests in 6 cabins with en-suite bathrooms and up to 36 crew.



Classic design



Main Salon

Her vintage interior design remains distinctive with outstanding details and spacious guest areas. The ambience, the rich antiques and the exclusive artisan woodwork can be seen in the famous movie “The Greek Tycoon” (1978), based on Onassis’ life with Anthony Quinn.





Elegant vintage



Cruising comfortably at sixteen knots, the vessel's spacious areas enable guests to enjoy both cosmopolitan ports of call and peaceful hideaways. With accommodation for up to eleven guests and superb amenities, Lady Sarya's luxurious atmosphere perpetuates her tradition as an exclusive ocean – going vessel.

Outstanding details



The upper deck leads onto the outdoor pool and to The Bar for an aperitif at sunset or an informal lunch.

Floating legend





The Bar





Artisan woodwork



Refurbished in 2020, the yacht is the ultimate combination of vintage ambience and classic luxury.

Understated luxury



Master Suite

The deluxe and spacious Master Suite is located at the Main Deck and occupies 100 sq.m. in total. It offers two bathrooms -His and Hers- and a separate Dressing Room with its own sitting area, all beautifully appointed in neutral colors.





Master Suite - Dressing Room



At the lower level each of the three cabins, the VIP Cabin and two Guest Cabins, all with en-suite bathrooms, display a unique charm with bright colors and the finest furnishings. Two additional cabins on the Upper Deck -one with single bed and one with double bed- complete the guest accommodation.





LADY SARYA







Technical Characteristics

LENGTH (LOA)	76 m
BREADTH max.	11.60 m
DEPTH	5.40 m
DRAFT	4.19 m
HULL / SUPERSTRUCTURE	Steel / Aluminium
MAX SPEED	18 kn
CRUISING SPEED	16 kn
RANGE AT CRUISING SPEED	3,200 nm

GROSS TONNAGE	1,031
NET TONNAGE	309
DISPLACEMENT F.L.	1,522 tons
DISPLACEMENT L.S.	1,207 tons
DEAD WEIGHT	315 tons





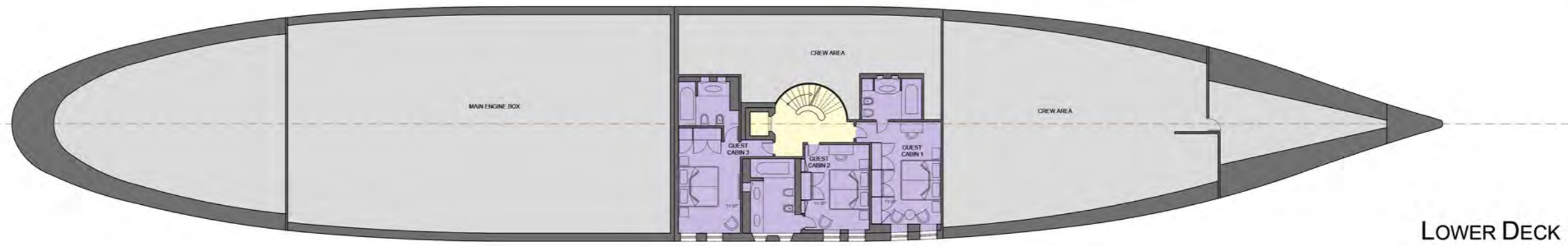
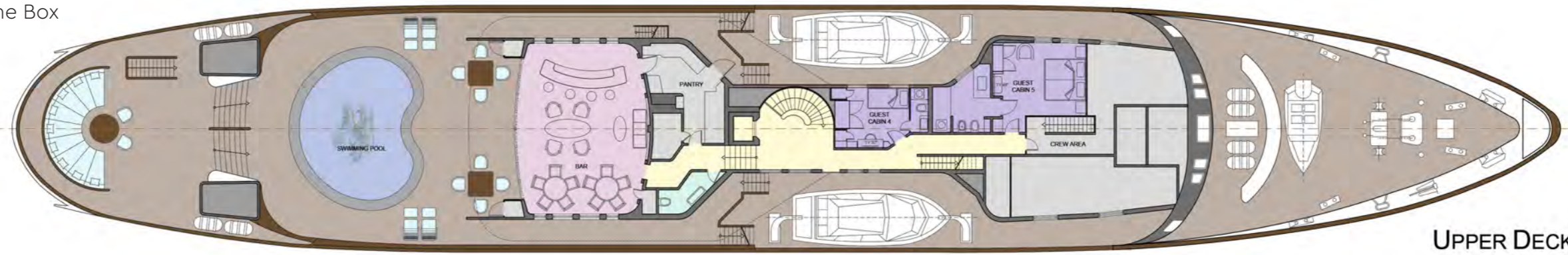
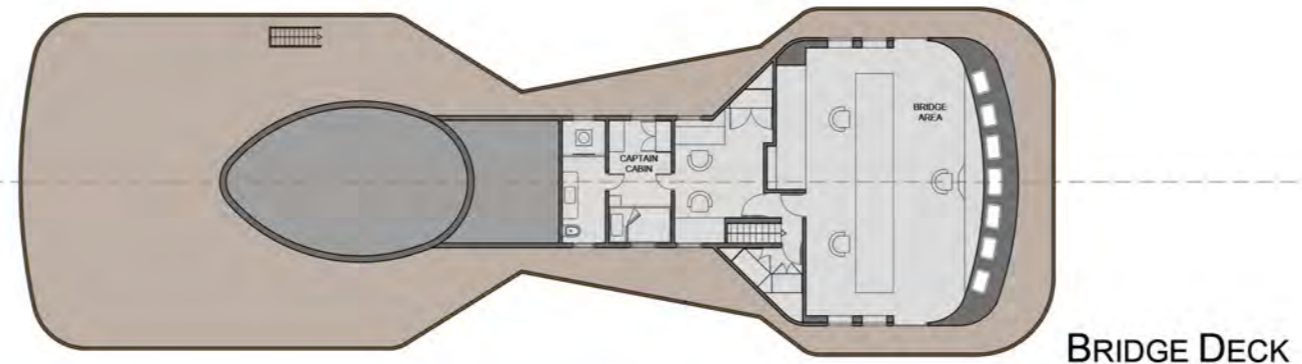

MAIN ENGINES	2MTU Marine Diesel Engines / 12V956TB-83N/ 2,210kw each RPM 1,400 max
PROPELLERS	Wartsila fixed pitch 5-plade / 2,105mm dia, Reduction 4:1 (1,400/370 rpm)
GEARBOXES	Lohmann & Stolterfoht Navilus GUW 600/1,265
GENERATORS	2 MTU Marine Diesel Engines / 12V183TE52 / 445kw each / RPM 1,500
EMERGENCY GENERATORS	Perkins 6-354T / 40kw
BOW THRUSTER	110 kw / Pleuger / 1,100mm diameter
FUEL TANKS	219,000 liters
LUBE OIL TANKS	4,850 liters
FRESH WATER TANKS	95,000 liters
WATER MAKERS	2 x 15m ³ per day

Yacht's Layout

-  Teak Floor
-  Lobbies - Corridors - Stairs
-  Main Lounge - Dining Room & The Bar
-  Master Suite - Dressing Room
-  Guest Cabins
-  Day Head
-  Crew Areas - Main Engine Box



Alternative 1 Layout – 17 Guests

-  Teak Floor
-  Lobbies - Corridors - Stairs
-  Main Lounge - Dining Room & The Bar
-  Master Suite - Family area
-  Guest Cabins
-  Day Head
-  Crew Areas - Main Engine Box

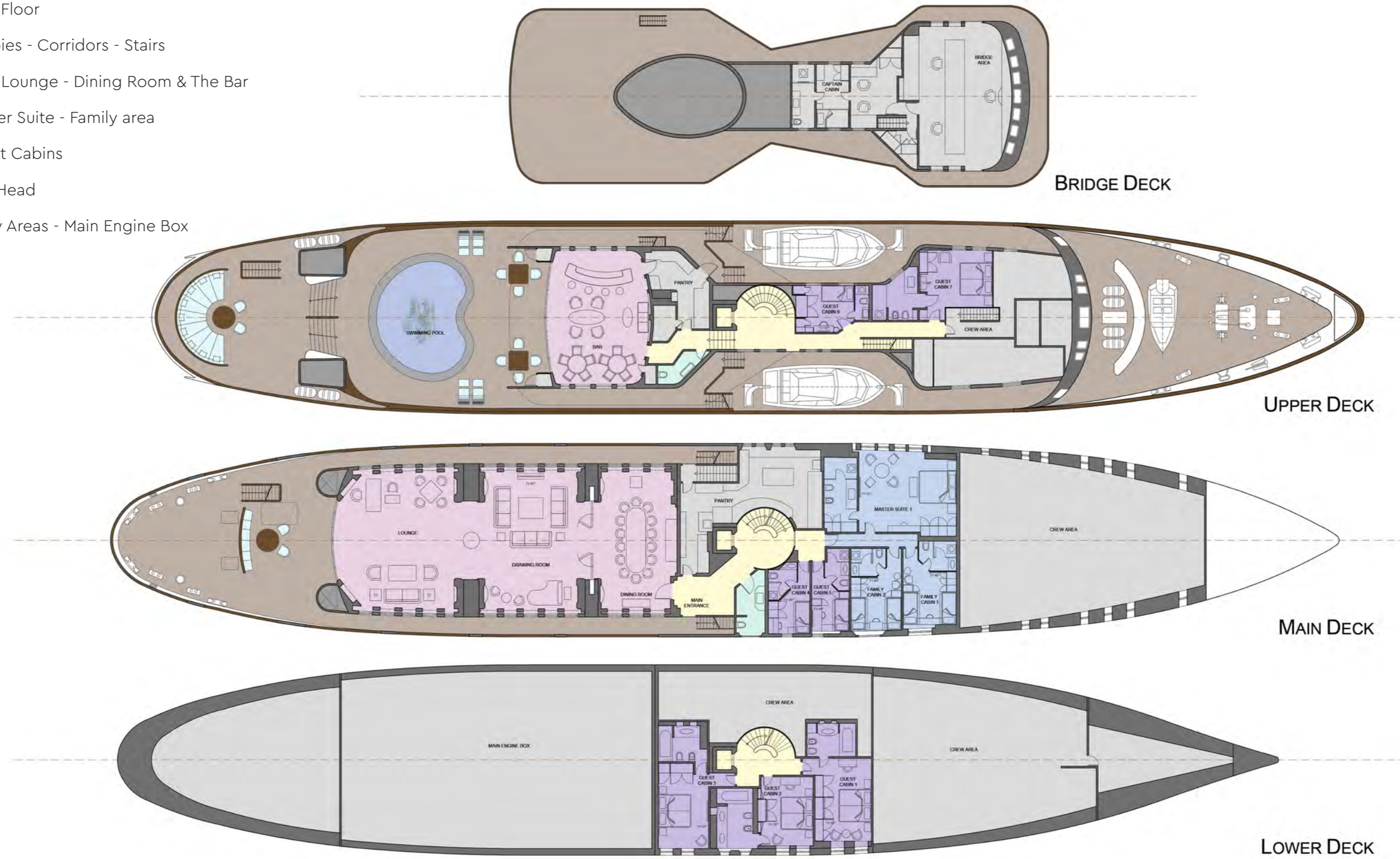

Alternative 2 Layout – 49 Guests

-  Teak Floor
-  Lobbies - Corridors - Stairs
-  Main Lounge - Dining Room & The Bar
-  Guest Cabins - Main Deck
-  Guest Cabins - Upper and Lower Deck
-  Day Head
-  Crew Areas - Main Engine Box

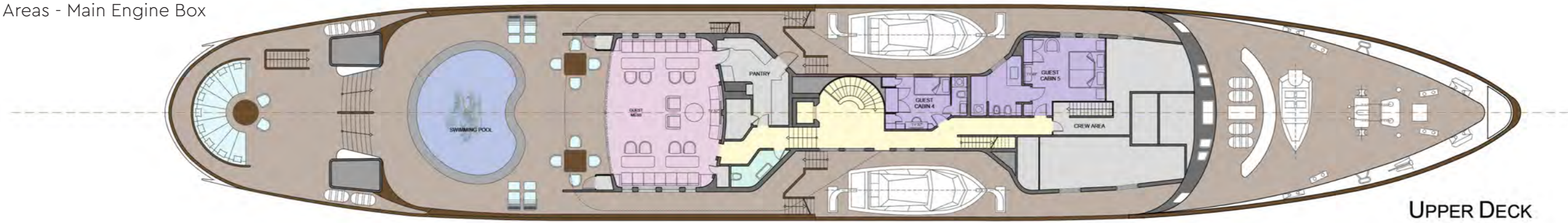
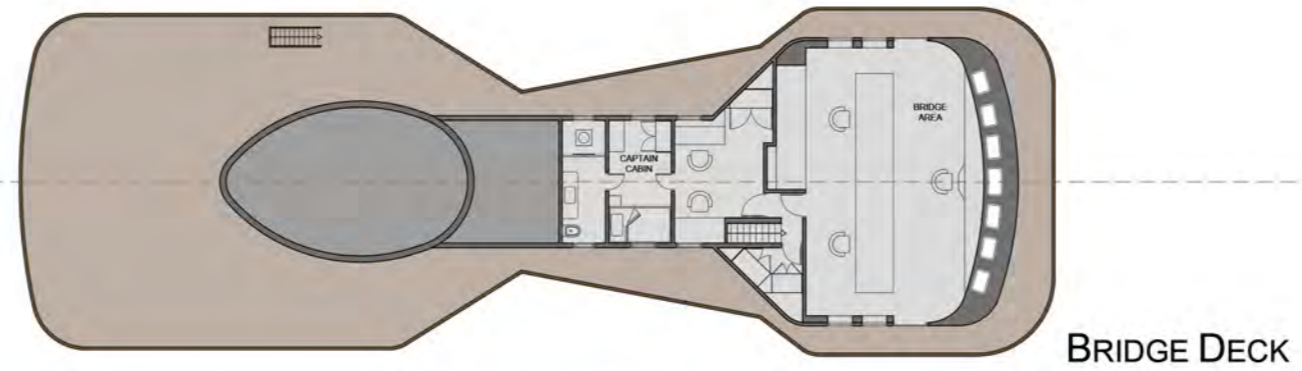



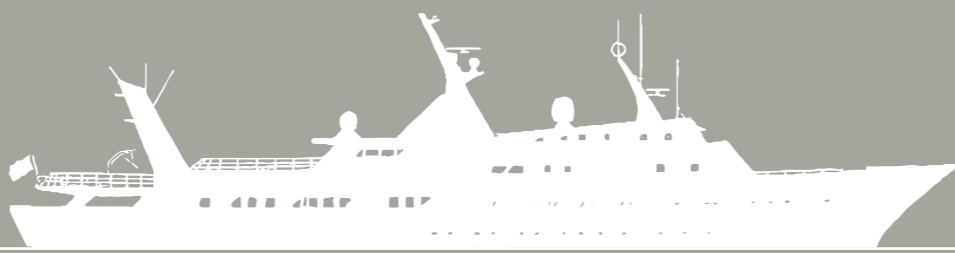

M / Y L A D Y S A R Y A